

## Box Header 2.0 mm

180° & SMT Series

### SPECIFICATIONS

Current Rating: 2 A  
 Insulator Resistance: 3000 MOhm min.  
 Dielectric Withstanding: AC 500 V  
 Operating Temperature: -40°C ~ +105°C  
 Soldering Temperature: 260°C for 3~5 sec. max  
 Contact Material: Copper Alloy  
 Insulator Material: Polyester, UL 94V-0  
 Standard: P.B.T.  
 Finish: Tin, Gold or Duplex Plated  
 Standard: Gold Flash all over  
 Note: Duplex Plating: Gold Plated on contact area, Tin on solder area

B414-SGP-D028/037-XX

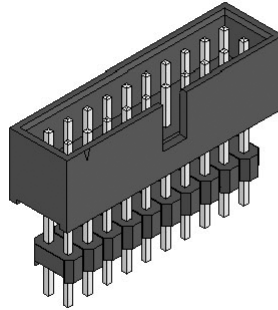

B414-M6GN-D073/030-XX-P

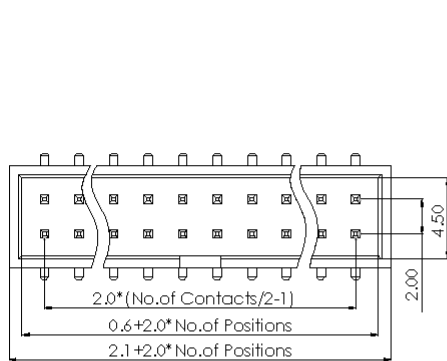
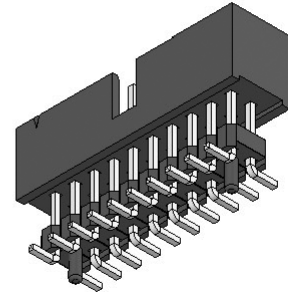

[B414]

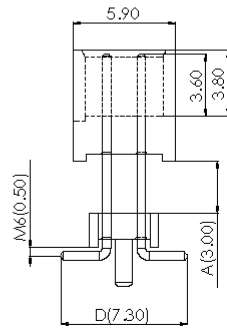
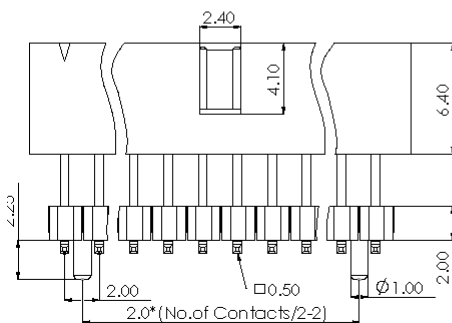
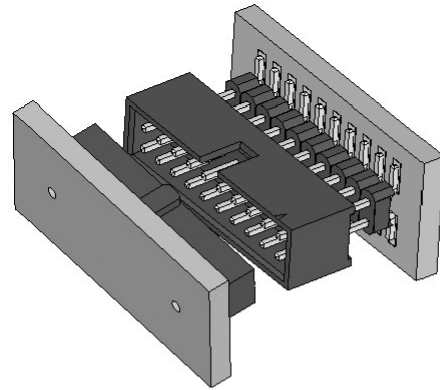
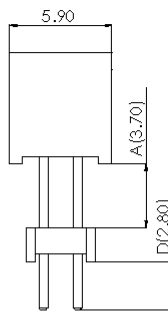

[B414] -P

### Recommended P.C.Board Hole Layout

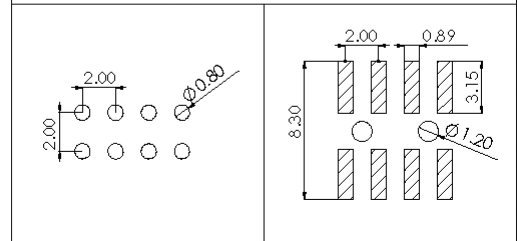

### How to order

Unit: mm

Series	Connector Type	Contact Plating	Material	Pin Length mm	Number of Contacts	Other
<b>BXXX</b>	<b>- X</b>	<b>X</b>	<b>X</b>	<b>- DXXX/XA</b>	<b>- XX</b>	<b>- P</b>
B414:B/H 2.00 H:6.40 Dual Row	S: Straight Type M: SMT Type M5: 0.32 M6: 0.50 M7: 0.65 .	G: Gold Flash T: Tin Plated A: 10U" Gold B: 15U" Gold C: 20U" Gold © Duplex Plating D: Gold Flash/Tin (Standard: G)	P: PBT N: Nylon-6T	S-D D028 (037) M-D D073 (030)	(10 TO 68 Contacts)	P: PEG